

# AMERICAN STRONG

## Classic Series

(A) Solid wood dovetail drawers ¾-inch thick; soft-close drawers and full extension drawer guides.



(B) Plywood finished ends on exposed cabinet ends.

(C) Light maple print interior (smooth white interior on thermofoil cabinets).

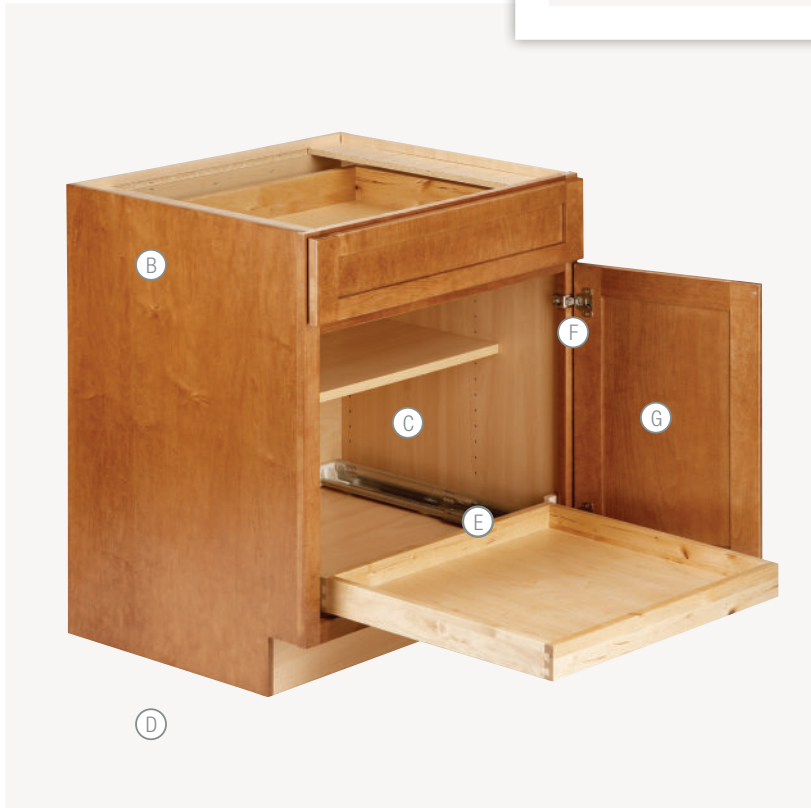

(D) Lifetime limited warranty.

(E) Drawer and slide-out trays with quiet-close, full-extension guides (slide-out tray is an upgrade).

(F) Soft-close hinges - door won't slam shut.

(G) Raised panel doors are a veneered center panel for stability and consistency with a solid wood frame.



[www.finelinehomes.com](http://www.finelinehomes.com)

#### PLEASE NOTE:

- Because all hardwoods have their own "personality" or special characteristics, variations in color, finish, grain pattern, and texture are to be expected. Yorktowne Cabinetry cannot be responsible for the variations within and between cabinets. These variations are naturally occurring and are considered acceptable, even desirable, because they result from the character and beauty of natural wood and/or hand-crafted finishing techniques.
- Due to chemical differences between printing inks and the pigments used in our manufacturing process, we cannot guarantee exact color reproduction of cabinet finishes in this brochure. Ultimate selection should be made from actual product samples.
- Specifications subject to change without notice or obligation to make changes in products previously produced. Changes may occur due to material availability and/or improvements in product design.



All cabinets bear the Kitchen Cabinet Manufacturer's Association certification label, which confirms compliance to the American National Standards Institute's performance guidelines for kitchen cabinetry.



© 2014 Elkay Manufacturing Co.

# Yorktowne®



## Kitchen & Bath Cabinetry Selections and Upgrades





# INCLUDED DOOR STYLES



**BRINKLEY**  
Available in: *Maple*  
Door Style: *Arch raised panel*  
Clayton door used on 9" wall and base cabinets  
Overlay: *Half*



**CLAYTON**  
Available in: *Oak, Maple*  
Door Style: *Raised panel*  
Overlay: *Half*



**COURTLAND**  
Available in: *Oak*  
Door Style: *Raised panel*  
Overlay: *Full*



**EVERETT**  
Available in: *Maple*  
Door Style: *Recessed panel*  
Overlay: *Full*



**FREEMONT**  
Available in: *Oak, Maple*  
Door Style: *Recessed panel*  
Overlay: *Half*



**HENNING**  
Available in: *Cherry, Maple, Knotty Alder, Hickory, Oak*  
Door Style: *Recessed panel*  
Overlay: *Full*



**JENNINGS**  
Available in: *Maple*  
Door Style: *Recessed panel*  
Overlay: *Full*



**KEELER**  
Available in: *Oak, Maple*  
Door Style: *Flat panel*  
Freemont door used on 9" wall and base cabinets  
Overlay: *Half*



**LENNON**  
Available in: *Cherry, Maple, Hickory, Oak*  
Door Style: *3/4" engineered material, edge banded*  
Overlay: *Full*



**PIEDMONT**  
Available in: *Oak*  
Door Style: *Raised panel*  
Clayton door used on 9" wall and base cabinets  
Overlay: *Half*

## Distinguished Cabinetry for Every Room in Your Home.

With nearly a century of experience crafting quality cabinetry, we understand the importance of workmanship, style and functionality.

Create a room that is uniquely yours by choosing from a wide variety of door styles. Five levels of finishes are available; some are an upgrade depending on the door style and wood species selected.



**TRENTON**  
Available in: *Thermofoil*  
Door Style: *Five-piece raised panel*  
Overlay: *Full*



**WEBBER**  
Available in: *Oak, Maple*  
Door Style: *Recessed panel*  
Overlay: *Full*



**WILDER**  
Available in: *Knotty Alder*  
Door Style: *Raised panel*  
Overlay: *Half*

# UPGRADED DOOR STYLES



**ANDOVER**  
Available in: *Thermofoil*  
Door Style: *Five-piece raised panel*  
Overlay: *Full*



**BRINKLEY**  
Available in: *Cherry*  
Door Style: *Arch raised panel*  
Overlay: *Half*



**CLAYTON**  
Available in: *Cherry*  
Door Style: *Raised panel*  
Overlay: *Half*

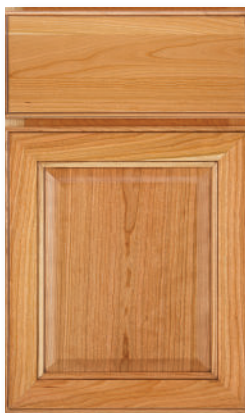

**COURTLAND**  
Available in: *Cherry, Maple*  
Door Style: *Raised panel*  
Overlay: *Full*



**CULLEN**  
Available in: *Cherry, Maple, Knotty Alder, Hickory*  
Door Style: *Raised panel*  
Fillmore door used on base cabinets  
Overlay: *Full*



**EVELYN**  
Available in: *Knotty Alder, Maple, Oak, Thermofoil*  
Door Style: *Beaded panel*  
Overlay: *Full*



**EVERETT**  
Available in: *Cherry*  
Door Style: *Recessed panel*  
Overlay: *Full*



**FILLMORE**  
Available in: *Cherry, Maple, Knotty Alder, Hickory*  
Door Style: *Raised panel*  
Overlay: *Full*



**GILFORD**  
Available in: *Thermofoil*  
Door Style: *Five-piece raised panel*  
Andover door used on base cabinets  
Overlay: *Full*



**JENNINGS**  
Available in: *Cherry*  
Door Style: *Recessed panel*  
Overlay: *Full*



**RILEY**  
Available in: *Cherry*  
Door Style: *Raised panel*  
Overlay: *Full*



**WEBBER**  
Available in: *Cherry*  
Door Style: *Recessed panel*  
Overlay: *Full*